

STEAM WAY® SIDEKICK 6100 OWNERS MANUAL



STEAM WAY 
INTERNATIONAL

1625 KDC Lane - PO Box 514 - Jackson WY 83001
1-800-447-8326 www.steamway.com

INDEX

Section	ITEM	Page
1	Warranty	2 – 4
2	Index of Figures, Pictures, and Illustrated parts breakdown	5
3	Safety	6
4	Operating Instructions	7
5	Water flow system (water pressure)	14
6	Recovery system	17
7	Scheduled maintenance	20
8	Illustrated parts breakdown	22 - 27

SECTION 1

- 1.1 This section contains warranty information about your machine – please read the warranty sheet page + the manufacturer’s warranty for each of the major components is listed. Every effort to consult the manufacturer’s representative in your local area is highly recommended.
- 1.2 A list of components manufactured by Steam Way is also listed with a warranty period from as high as five years to a minimum of 90 days depending on the particular part.
- 1.3 When parts are covered under warranty by Steam Way International, the defective part must be returned freight pre-paid to Steam Way to receive credit. A return authorization is required when returning parts.



TRUCK MOUNT

Platinum Plus Protection Plan

LIMITED WARRANTY ON TRUCK MOUNT EQUIPMENT

Steam Way® International, Inc. (hereafter referred to as Steam Way®) warrants to the original purchaser or lessee that each truck mounted machine sold will be free from manufacturing defects in materials and workmanship. Components, accessories and parts used on Steam Way® machinery and equipment, not manufactured by Steam Way® International, are not covered in any way by the warranty, and are subject only to their original manufacturer's warranty. Included with this limited warranty is a partial list of components and their warranty periods. No person, including any distributor or representative of Steam Way® is authorized to make any representation on behalf of Steam Way®, or to assume for Steam Way® the obligations contained in this warranty. Unauthorized replacement or repair of parts without Steam Way®'s written consent automatically voids this limited warranty.

Steam Way®'s obligation under this warranty is limited to repairing or replacing products at Steam Way® International, Denver, Colorado or at a service facility designated by Steam Way®, if returned within the warranty period. Customer must obtain a return authorization number from the factory and return the product prepaid. Upon examination, if the part is deemed by Steam Way® to be defective within the warranty period, Steam Way® will pay transportation and freight charges (Normal Ground Shipping) of the replacement or repaired part.

This warranty is valid only if Steam Way®'s products and machinery are operated under normal conditions with competent personnel and supervision and maintained in accordance with Steam Way®'s maintenance schedules and instructions as detailed in equipment manuals. The purchaser agrees that he/she will use, in the operation of his/her machine, only company authorized parts, equipment, lubricants, and chemicals, which are to be furnished through Steam Way®, or approved in writing by Steam Way®. Violation of this point may lead to invalidation of the warranty coverage of the various components of the equipment. This warranty is also subject to the following conditions:

1. Machine must be protected from freezing conditions.
2. Only Steam Way® cleaning chemicals and cleaning chemicals approved by Steam Way® may be used in conjunction with operation of the said machine and equipment. Steam Way® chemicals or approved chemicals must be used in accordance with labeled directions. The use of acid rinse or acid extraction detergents, not authorized by Steam Way®, shall invalidate all warranty coverage for heating system coils, waste and solution tanks, and brass fittings.
3. Lubrication of components must be with Steam Way® approved products and changed in accordance with Steam Way® Service Manuals.
4. Poor water quality, which results in chemical deposits in heating or plumbing systems, invalidates warranty protection.

The remedies provided herein are the customer's sole and exclusive remedies. Steam Way® shall not be liable for special, indirect, incidental or consequential damages of any kind. This includes, but is not limited to, downtime or loss of business revenue, and transportation costs of equipment to authorized warranty service site. Seller's and manufacturer's liability for any and all losses or damages, resulting from any cause whatsoever, shall in no event, exceed the replacement cost of the defective part. Before using, the purchaser and/or user shall determine the suitability of the use of the equipment for his/her intended use, and user assumes all risk and liability whatsoever, in conjunction therewith. Limited Warranty set forth herein is in lieu of all other warranties, expressed or implied, without limitation, any warranties of merchantability or fitness for a particular purpose and all such warranties are hereby disclaimed and excluded by the manufacturer, Steam Way® International, Inc.

Steam Way®, at any time, reserves the right, at its discretion, to change, alter, or modify the material, design, equipment, or any component part thereto comprising the equipment, as well as any accessory, including, but not limited to, machine parts.

If, at any time during this warranty period, the purchaser's unpaid account with Steam Way® or any one of its authorized service or distribution centers, shall exceed thirty (30) days from the date of invoice, or if a check is given to Steam Way® that does not clear Steam Way®'s bank, or is uncollectible for any reason, Steam Way® reserves the right to discontinue service, including but not limited to supplying replacement parts, pending satisfactory payment of account.



TRUCK MOUNT

Platinum Plus Protection Plan

LIMITED WARRANTY ON TRUCK MOUNT EQUIPMENT

<u>COMPONENTS</u>	<u>PERIOD OF WARRANTY</u>
TRUCK MOUNT MANUFACTURED PARTS.....	5 Years
Including: Frame, Front Panels, plates, brackets, etc., (Excludes paint and silkscreen)	
Excluding: Waste Tank, Holding Tank, Solution Tank.....	2 Years
MANUFACTURED HEATER COMPONENTS.....	1 Year
SS Thermal Accumulator Coil (Sidekick 6100), Preheater Coil (Sidekick 6100) Primary Heater Coil (Sidekick 6100)	
WANDS AND HAND TOOLS.....	5 Years
Including: Scrub Wand, Hydro-Kinetic Tool, Standard Upholstery Tool, Short Handle Stair Tool (Does not include normal wear on Scrub Wand which requires resurfacing)	
Exceptions: Valves, Jets.....	90 days
BELTS, GAUGES*, FILTERS, QUICK CONNECTORS, VISI-FLOW SOLUTION METER.....	1 Year
*Exception: Pressure Gauge..... 90 days	
SOLUTION (PRESSURE) HOSES, VACUUM HOSES.....	90 days
OTHER ITEMS (This is not a complete listing).....	90 days
All instruments, switches, and controls. All electrical components. All valves and regulators. All pulleys. Diverter Valve, Pressure Cylinders, Meters	

There is no warranty on pump cups, valves, O-rings and seals, and roof vents.

BELOW ITEMS ARE COVERED THROUGH ORIGINAL MANUFACTURER S WARRANTY

Engines 20 and 25 H.P. Kohler Command Engines	2 Years
16 H.P. Briggs & Stratton Vanguard Engine	1 Year
*Ignitor	1 Year
Blower (Tuthill)	18 Months*
Pressure/Solution Pump (Cat)	2 Years
Generator (2100)	1 Year
Alternator (4100 LX)	90 days
Burner (solenoid, transformer)	3 Years
Burner Coils (PowerMatic 2100 _u , 4100 LX).....	1 Year
(Except when frozen)	
Silencers	1 Year

This is not a complete list of trade warranties * - Warranty Notes Is From Date Of Manufacture Of Blower
Effective on Steam Way[®] Truck Mounts Shipped After 6/05. Revised 8/05.

SECTION 2

List of Figure Numbers, Pictures and Illustrated Parts Breakdowns

Figure Number	Title	Page
4-1	Unit Front View	9
4-2	Unit Right View	10
4-3	Unit Left View	11
4-4	Unit Rear	12
4-5	Unit Top	13
5-1	Water Flow Diagram (Water Pressure)	16
6-1	Recovery System (Vacuum)	19
7-1	Maintenance Schedule	21
8-1	Water Holding Tank	22
8-2	Front Panel Side View	23
8-2.1	Front Panel	24
8-3	Water Pump and Regulator	25
8-4	Belt and Drive Components	26
8-5	Water Heating Components	27

NOTE: Parts breakdown and additional information for the three major components for this machine are located after the PARTS tab in this manual.

- A. Engine
- B. Water Pump
- C. Vacuum Blower
- D. Cleaning Tools

SECTION 3 SAFETY

- 3.1 This section may be the shortest section in your tech manual, but may also be the most important. It is our desire at Steam Way International that you have many years of satisfactory use, with no injuries to the operator, maintenance personnel, customers, or onlookers. If the operator uses good safety practices, the likelihood of injuries will be minimal.
- 3.2 Carbon Monoxide is emitted by the gasoline engine and could become lethal if the unit is operated in a confined area. Carbon Monoxide is odorless, colorless and can cause death if inhaled. Never run the engine in a closed garage or similar area. Look for and consider the following:
- A. Location of the vehicle
 - B. Wind direction
 - C. Dizziness
 - D. Unexplained headaches
 - E. Symptoms of others who are exposed to situation
- 3.3 Hot exhaust tubes will cause burns to the hands and arms if touched while they are hot. When you are performing service or maintenance, use much caution.
- 3.4 Moving parts can cause injuries if safety precautions are ignored. Always keep loose clothing away from pulleys, belts and shafts when maintenance procedures must be performed, while the engine is operating. Loose clothing can become tangled and caught in the machine's moving parts and can pull the hand or arm into pulleys or belts, causing personal injury.
- 3.5 The battery contains sulfuric acid. To prevent burns acid burns, avoid contact with skin, eyes and clothing. Batteries produce an explosive hydrogen gas while being charged. To prevent a fire or explosion, charge batteries only in a well ventilated area. Keep sparks, open flames, and other sources of ignition away from the battery at all times.
- 3.6 Gasoline is an explosive fuel. Gasoline is extremely flammable and its vapors can explode if ignited. Do not fill the tank while the engine is running, since spilled fuel could ignite if it comes in contact with sparks. When removing the fuel cap to fill the tank or venting the tank, use extreme caution to assure that no cigarette or other live flames or sparks are near. If gasoline comes in contact with the skin, wash it off immediately.

SECTION 4 PRE-OPERATING INSTRUCTIONS

4.1 Before starting –

1. Read your technical manual
2. Fill the gasoline tank - see engine manual located after the Parts tab.
3. Fill solution bottle with desired solution
4. Check oil level in engine, water pump and blower
5. Remove antifreeze from the unit (initial start up after delivery only)
 - a. Insert the input water hose assembly into the quick disconnect near the white in-line filter
 - b. Remove the male pressure out connector from the front panel
 - c. Turn the water inlet valve on and allow all the antifreeze to be forced out
 - d. Reconnect the hoses and connectors to the original configuration
6. Connect the water input vacuum hose and pressure out lines to machine.

4.2 Starting engine – (see starting and stopping in your engine manual, page 4)

1. Pull choke all the way out (closed)
2. Throttle to fast position (throttle is set for approximately 3300 RPM)
3. Turn ignition switch to start position using short starting cycles (15 seconds per minute) to prolong starting life
4. When engine starts return choke to full in position (choke off)

4.3 Operating the unit –

1. Immediately after the engine starts, check for water pressure. CAUTION: If water pressure is not observed on pressure gauge, stop unit and force feed the pump as described in step 5.a. (above) before starting procedure.
2. The water pressure may be set to the desired pressure by pulling the black plastic cover from the regulator. Loosen the jam nut, then adjust to the desired pressure (maximum 800 PSI).
3. The solution control may be set to the desired GPH (gallons per minute), but will only indicate flow when the tool is on. CAUTION: Do not let the solution container run dry because this will cause the pump to lose pressure possibly causing damage to the pump.
4. CAUTION: Do not leave the unit running for more than 5 minutes without tool operation. Serious damage could result.

5. When doing water extraction only, certain precautions must be observed.
 - a. Water supply must be connected to the machine
 - b. Water must flow from the pressure output of the machine. This can be accomplished by using a cleaning tool or bleeder valve to assure that water flows from the machine.

4.3 Unit shut down – (see stop engine instructions of engine manual, page 4)

1. Slowly retard the throttle to idle speed
2. Let the unit run at idle speed for 30 seconds
3. Turn key to off position. NOTE : Do not pull choke to make engine stop.

**FIGURE 4-1
UNIT FRONT VIEW**

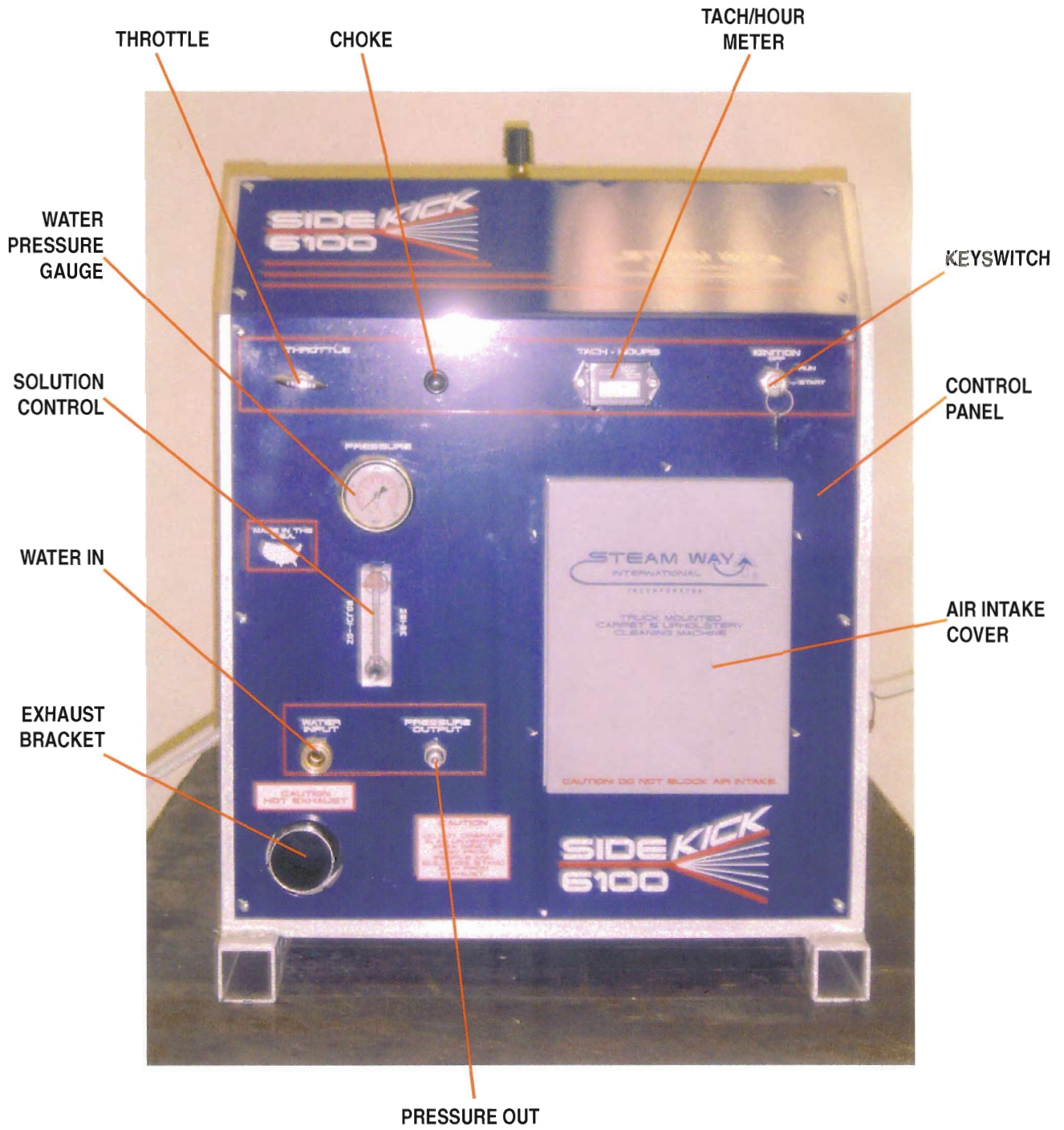

**FIGURE 4-2
RIGHT SIDE VIEW**

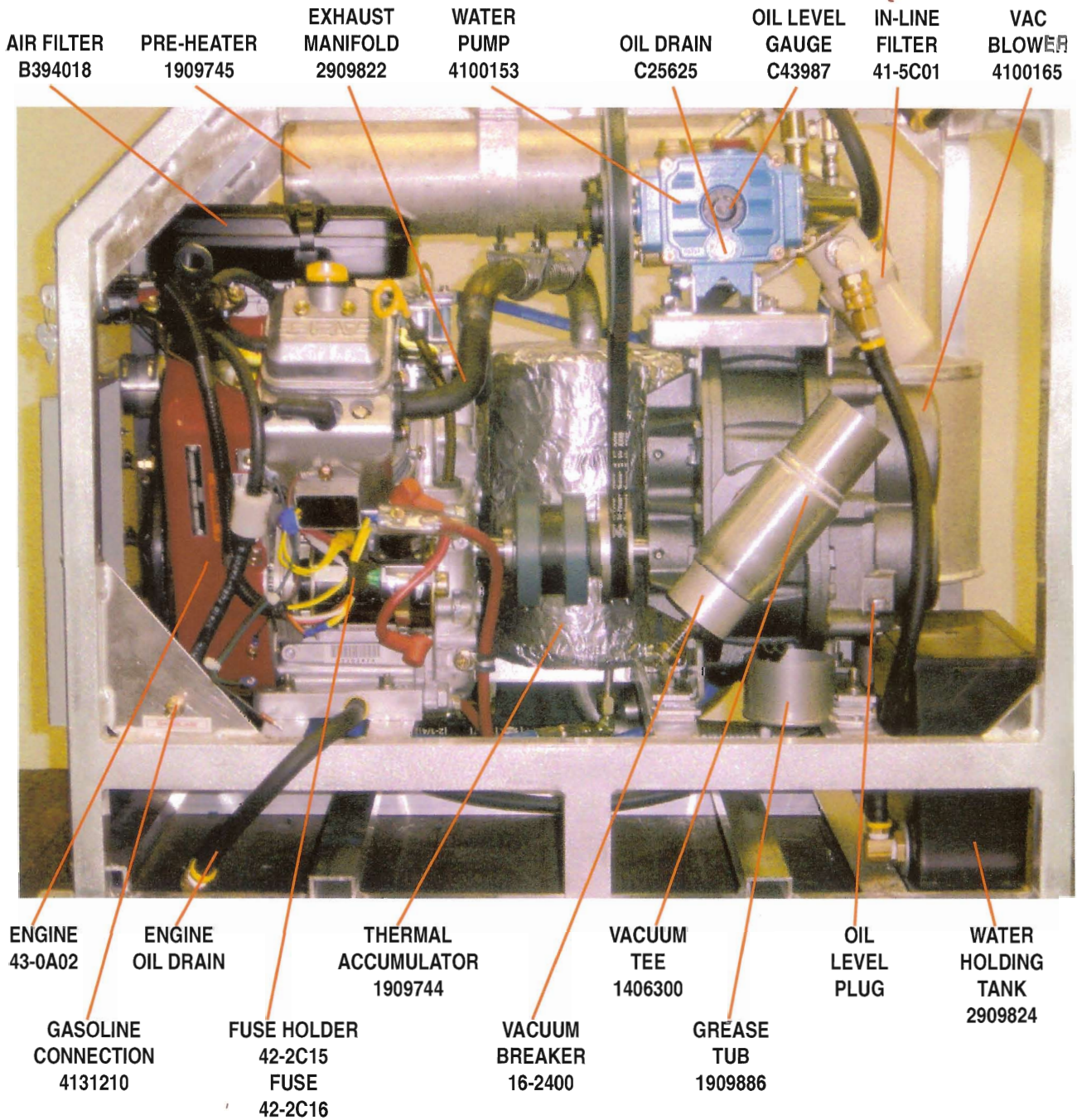

**FIGURE 4-3
LEFT SIDE VIEW**

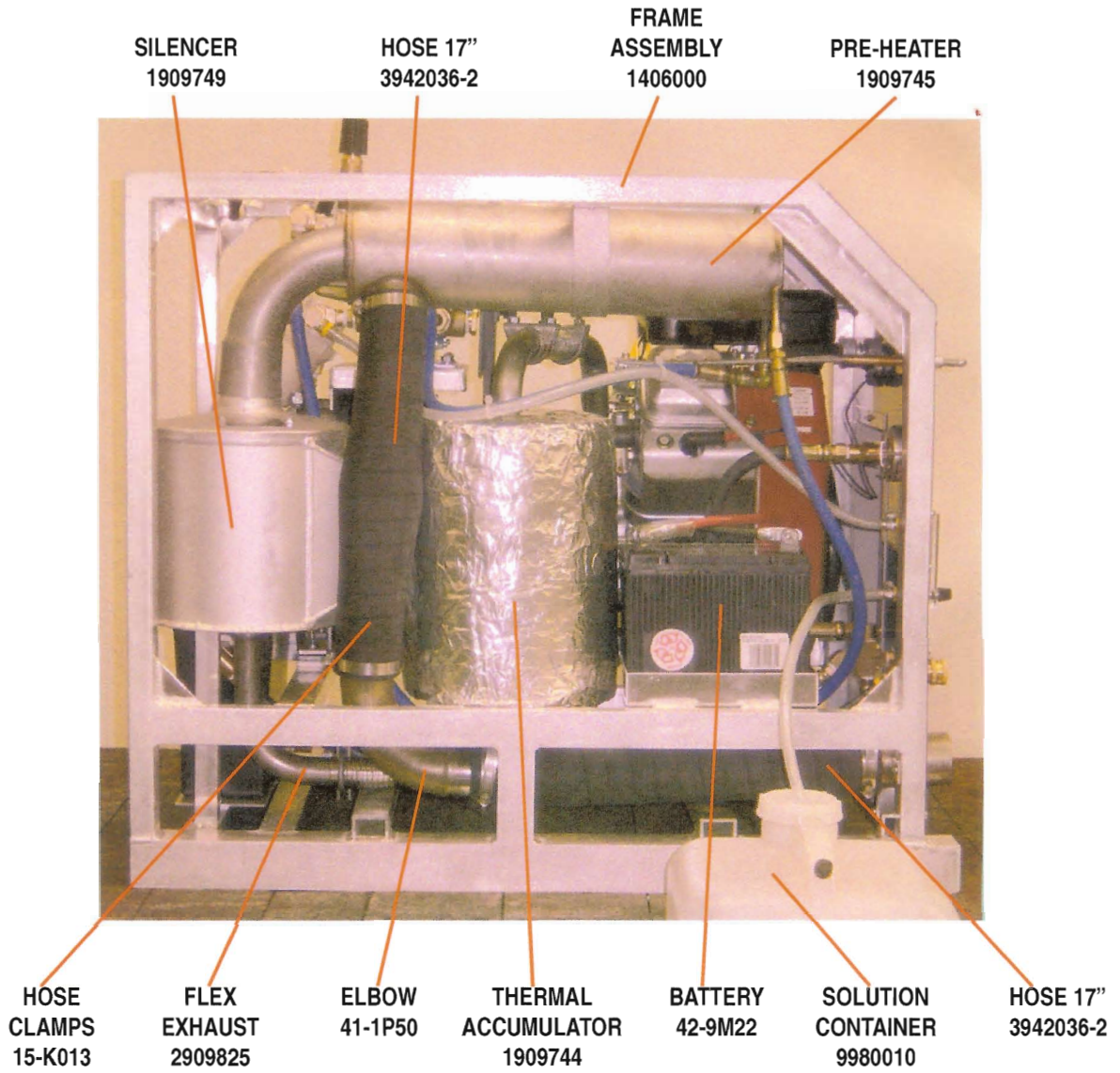

**FIGURE 4-4
UNIT REAR VIEW**

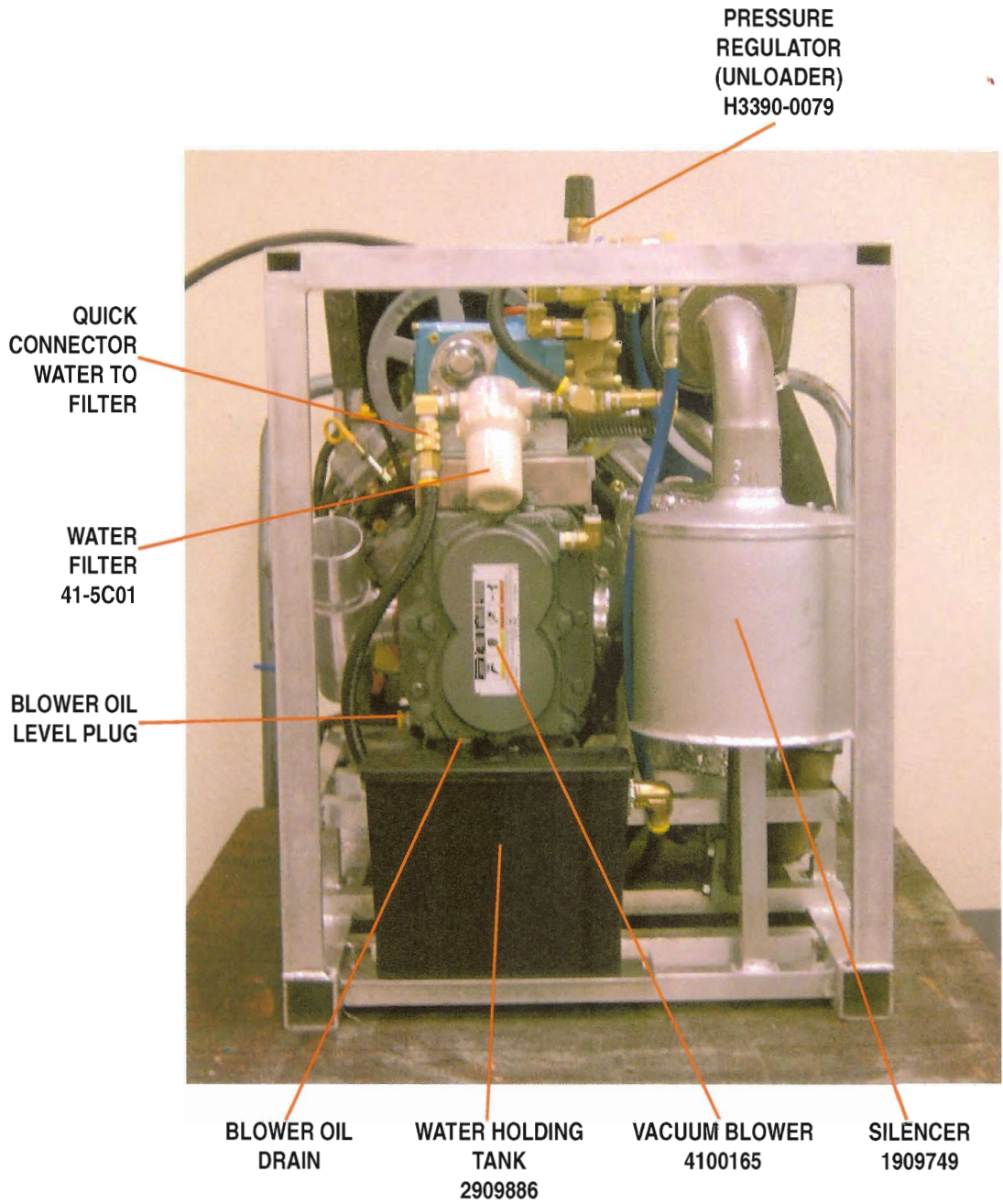

**FIGURE 4-5
UNIT TOP VIEW**

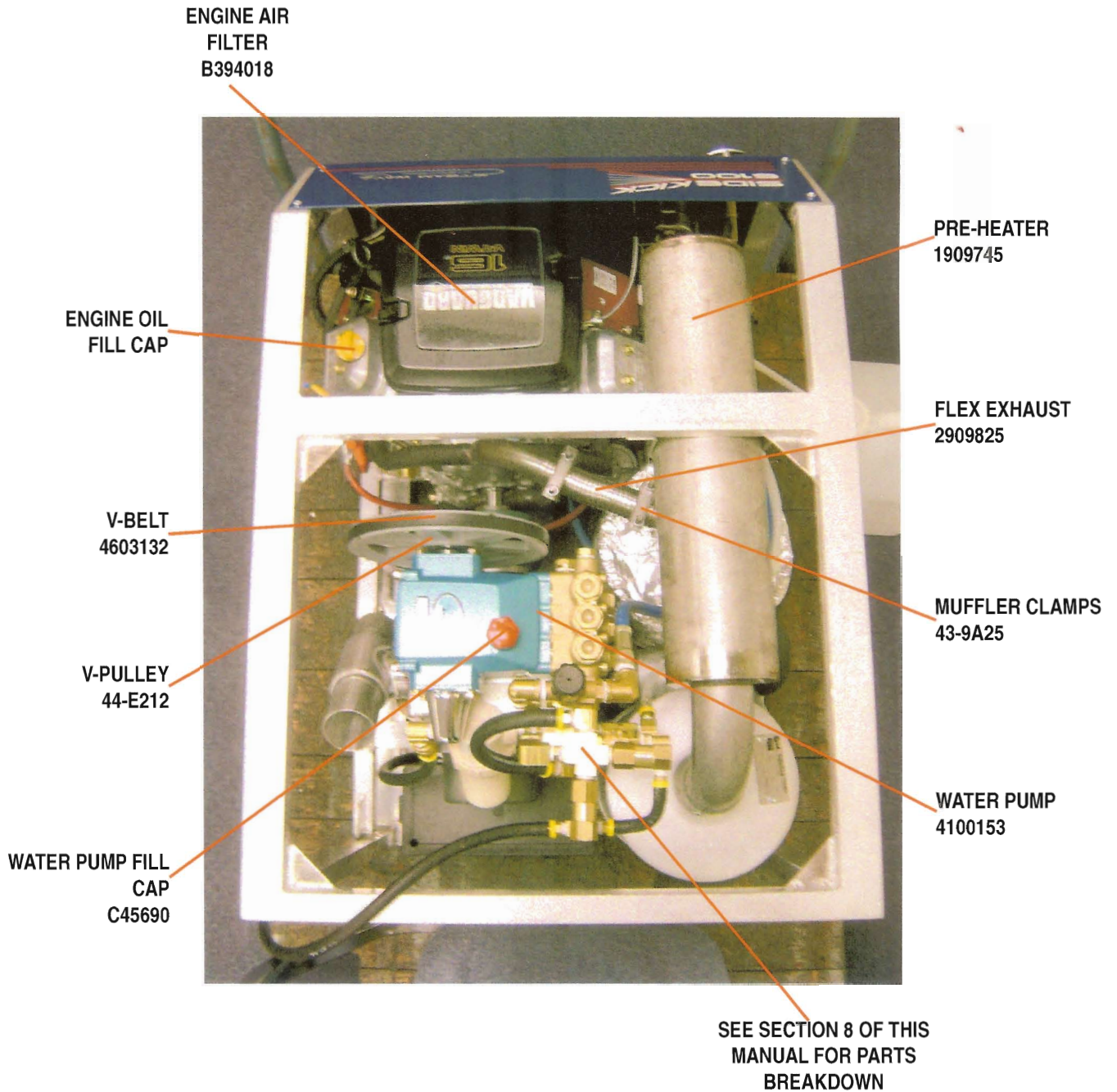

SECTION 5 WATER FLOW SYSTEM

- 5.1 Refer to figure 5-1 page while reviewing the water flow system. The water pump draws water from the water holding tank that is filled with the input water hose and valve assembly directly from the customer's water faucet. The pump also draws solution from the solution container, which is controlled by the solution control meter on the front panel. This part of the system cannot tolerate an air leak.
- 5.2 The water and solution that has been drawn into the pump is then forced out through the discharge connection of the water pump and sent to the pressure regulator (unloader). The pressure regulator unloads all the excess water or pressure back to the suction side of the water pump, so that a desired water pressure can be maintained. Do not exceed 800 PSI.
- 5.3 The regulated water pressure from the pressure regulator is sent to the pre-heater where the first stage of heating is accomplished. From the pre-heater the water goes to the thermal accumulator for the final stage of heating.
- 5.4 The output of the thermal accumulator goes to the 4 way cross on the front panel where the pressure output connector and the water pressure gauge are connected. NOTE that from the 4 way cross a small amount of the hot water is sent back through the orifice bypass screen QD to another 4 way cross near the pressure regulator and water pump. This 4 way cross has two thermal valves attached that will open when the returned water reaches a temperature of 145 degrees Fahrenheit.
- 5.5 The returned water is a combination of the hot water from the 4 way cross on the front panel and the unloaded water from the pressure regulator. When or if this condition occurs the thermal valves will open, discharging the hot water to the waste tank, always keeping the water at a safe temperature for the water pump.
- 5.6 The orifice bypass screen must be checked frequently. If it becomes clogged pressure and temperature spikes will occur.
- 5.7 The water pump cannot be run dry of water because serious damage will result and the warranty will be voided. If no water pressure is observed on the pressure gauge, it is apparent there is no water in the pump. (To regain water pressure, connect the input hose and valve assembly to the quick connect at the water filter).

5.8 The water pump must always have an adequate amount of oil in the crankcase. The level of oil can be observed on the sight window (red dot) on the pump. Refer to the maintenance checklist (Figure 7-1) in this manual for proper type of oil and frequency of maintenance. A cat pump manual is located after the Parts tab.

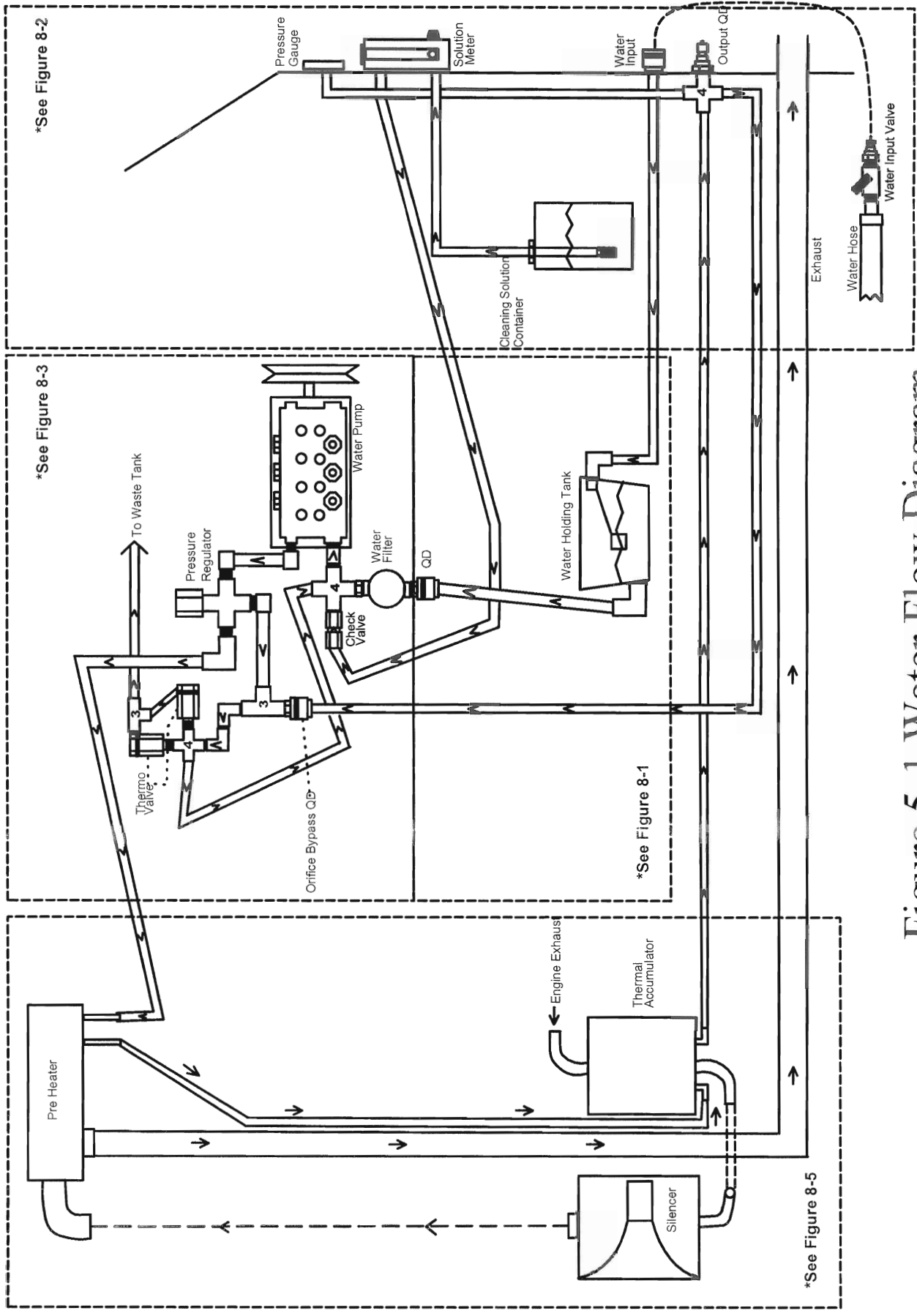

Figure 5-1 Water Flow Diagram

SECTION 6 RECOVERY SYSTEM

- 6.1 If it could be determined which specific part of the cleaning process (pressure, heat, or vacuum) is the most important one, probably the recovery (vacuum) would head the list. Even with the superb water pressure, cleaning agents and heat, if you can't recover soil that has been dislodged, the cleaning process has NOT been accomplished. A thorough knowledge of the recovery system is very important to keep this system at its peak performance.
- 6.2 The vacuum blower Fig. 6-1 is the heart of the recovery system. While the engine operates at 3300 RPM, it turns the blower shaft at a 1:1 ratio or operating speed. This causes the blower to pull a large volume of air.
- 6.2.1 To sustain long life for the vacuum blower, it must be serviced properly. The gears must be lubricated with gear oil (pneulube) and bearings must be greased (high speed high temperature grease). The maintenance check list (figure 7-1) suggests the frequency for service, and the part numbers. The blower holds 6 ounces of gear oil.
- 6.2.2 The level for the oil in the gear case can be checked by removing the oil level plug (see Figure 6-1) on the gear housing. If the oil comes out, the oil level is sufficiently high enough. The two grease fittings for the bearings are located on the opposite side of the blower near the drive shaft.
- 6.3 In referring to Figure 6-1, it is shown that air from the cleaning tool, travels through the connecting vacuum hoses, and is emptied into the waste recovery tank at the vacuum hose connection. At this point, water, soil, and debris are dropped to the bottom of the tank, but the air continues on into the vacuum blower. The silencer not only receives the air from the blower, but also receives the exhaust from the engine. All of the air and exhaust are expelled through the preheater and finally, to the exhaust port on the front of the machine.
- 6.4 A vacuum relief breaker is installed on vacuum "T" (Figure 6.1). The vacuum breaker is preset at the factory and should not have to be reset. The purpose of the vacuum breaker is to relieve the load on the engine and vacuum blower at predetermined values at predetermined values of Hg.

6.5 To check the recovery (vacuum) system to ensure peak performance, inspect the following:

1. Clean lint screen
2. Dump valve closed
3. Seal around the lid of waste tank
4. Condition of vacuum hoses and cuffs
5. Inspect the cleaning tool for clogged air passage.

6.6 After a known blow-over (dirty water being pulled into and through the blower), the impellers should be cleaned and oiled. Press the vacuum breaker in and allow water from the water input hoses to be drawn into the blower at a slow rate. After approximately one or two pints of water have been inserted into the vacuum blower, allow the blower to air dry for about three minutes. After the blower has dried, insert a small amount of oil or spray WD-40 into the blower to lubricate the impellers.

6.7 A blower manual provided by the blower company is located after the Parts tab in this booklet which will give much added information about the blower.

CAUTION: DO NOT LET THE BLOWER PULL ANYTHING INTO THE BREAKER (i.e., loose objects, etc.); SERIOUS DAMAGE WILL RESULT.

**FIGURE 6-1
RECOVERY SYSTEM**

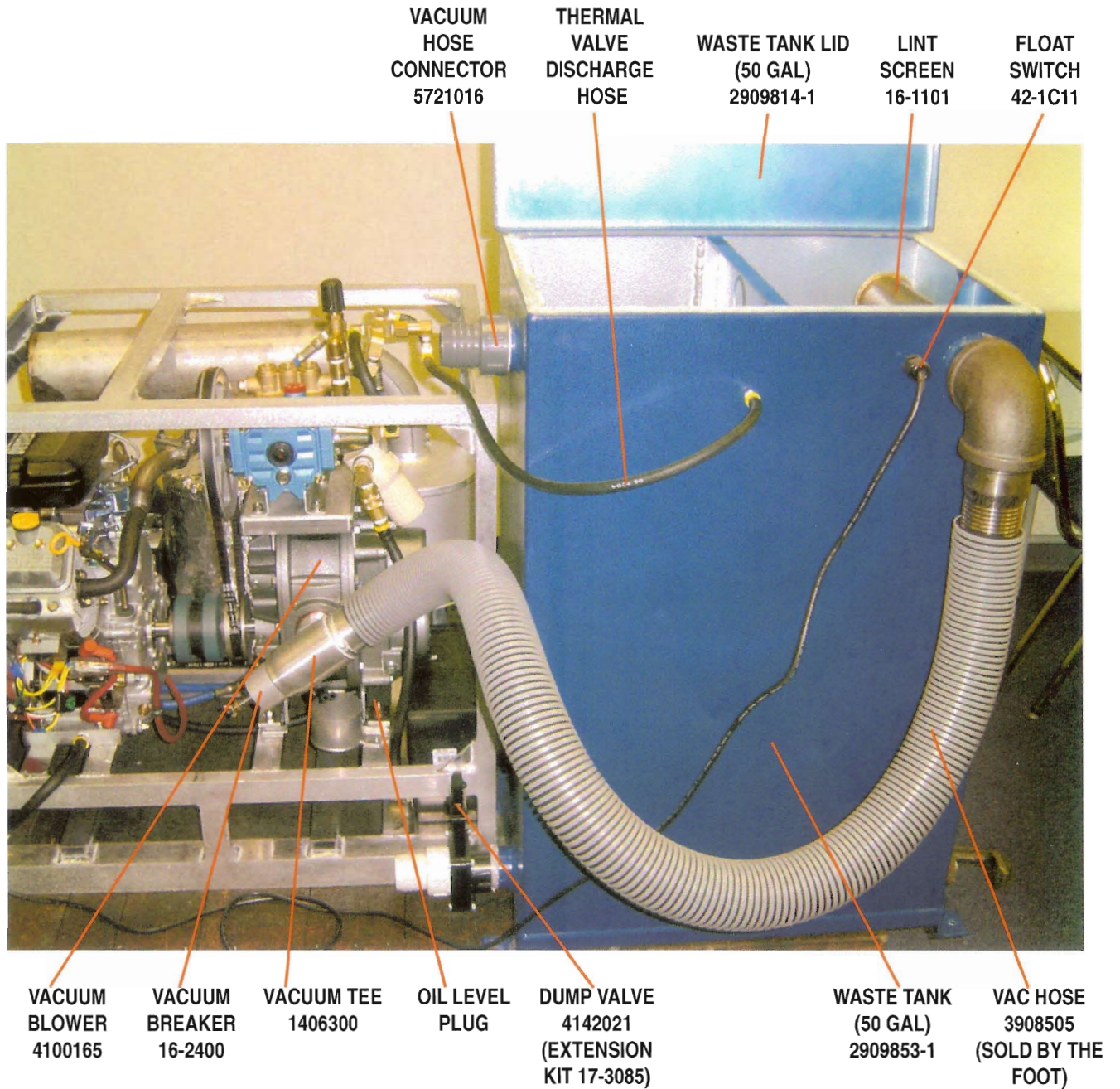

SECTION 7 MAINTENANCE

- 7.1 The maintenance checklist, Figure 7-1, covers the items and the frequency of maintenance required for the Sidekick. The first column lists the items needing service; the center columns give the frequency of maintenance to be performed; and the last column gives the product to be used along with the part number of that product.
- 7.2 A maintenance log should be kept for a history of the maintenance performed.
- 7.3 Note that within this manual, you will find the owner's manuals for the engine, blower and water pump. In each of these manuals you will find service and maintenance instructions. These manuals are located after the Parts tab.

FIGURE 7-1 MAINTENANCE CHECK LIST: SIDEKICK 6100

ITEM	EVERY JOB	EVERY DAY	EVERY WEEK	50 HOURS	100 HOURS	500 HOURS	12 MONTHS	PRODUCT (AVAILABLE AT STEAM WAY INT'L or DISTRIBUTOR)
Lint Screen Waste Tank	Clean							Part Number #16-1101
ENGINE (change oil after first 8 hours, then every 50 hours thereafter)								
Oil		Check		Change				30 Weight High Detergent
Oil Filter				Change				Part #B492932
Air Filter				Check	----- (Replace if dirty) -----			Part #B394018
Spark Plugs						Change		Champion RC12YC Part # K1213202
Check Valve Clearance						Check		Authorized Engine Dealership
ORFACE BYPASS SCREEN								
Screen			Check					Replace Complete Assembly part #1909879
CAT PUMP								
Cat Pump Oil		Check (red dot)				Change		Special Cat Oil Part# 4810106
VACUUM BLOWER								
Crank Case Oil			Check			Change		Tuthill Blower Oil Part #4100158-1
Bearing Grease			Lube					High speed, high temperature
Lube Impellers		Lube						See recommended lubricants in blower manual page 15

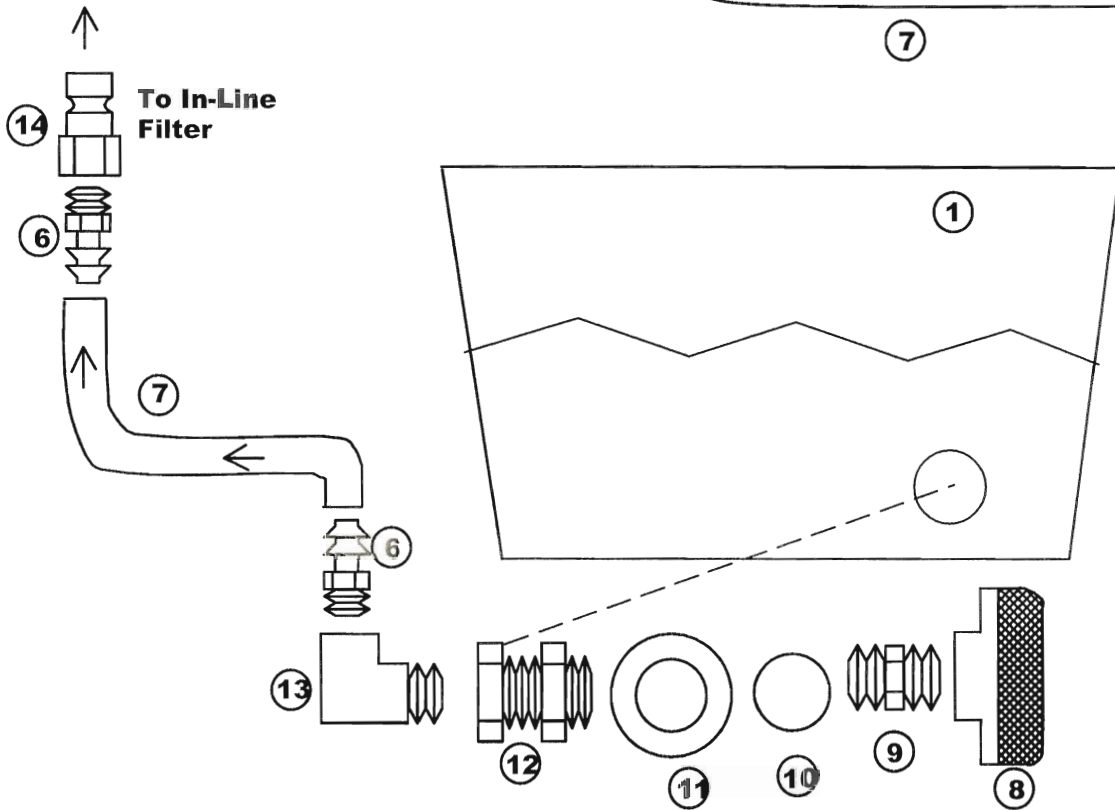
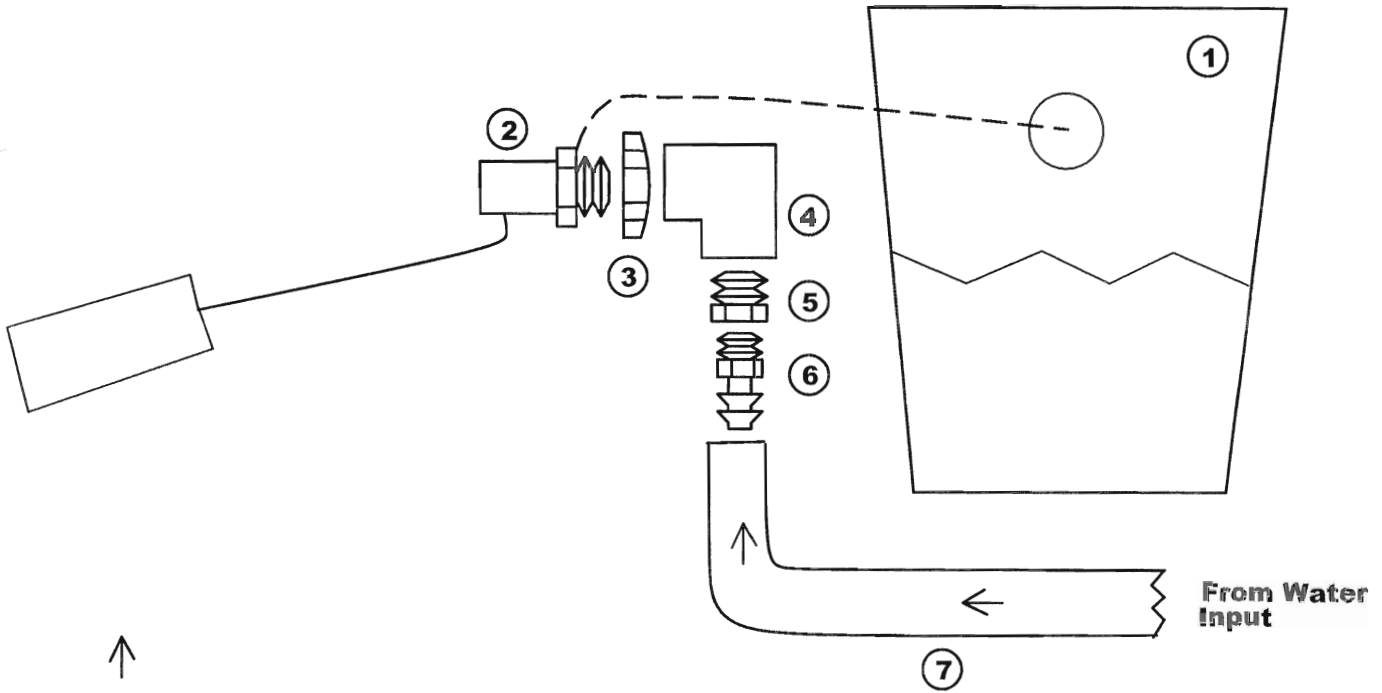

1	2909824	TANK W/COVER	8	41-5C14	STRAINER
2	4143110	FLOAT VALVE	9	41-1H33	3/8 HEX NIPPLE
3	42-9M34	1/2 CONDUIT NUT	10	45-C002	O-RING
4	41-1C04	1/2 ELBOW	11	21-1003	RECESSED WASHER
5	41-1A32	BUSHING 1/2 x 3/8	12	41-1D03	BULKHEAD FITTING
6	41-1M32	BARB 3/8hose x 3/8mpt	13	41-1C13	3/8 STREET ELBOW
7	3941006	3/8 PUSH LOCK HOSE*	14	4131660	3/8 MALE QD

*This hose is sold by the foot - indicate desired length.

Figure 8-1 Water Holding Tank

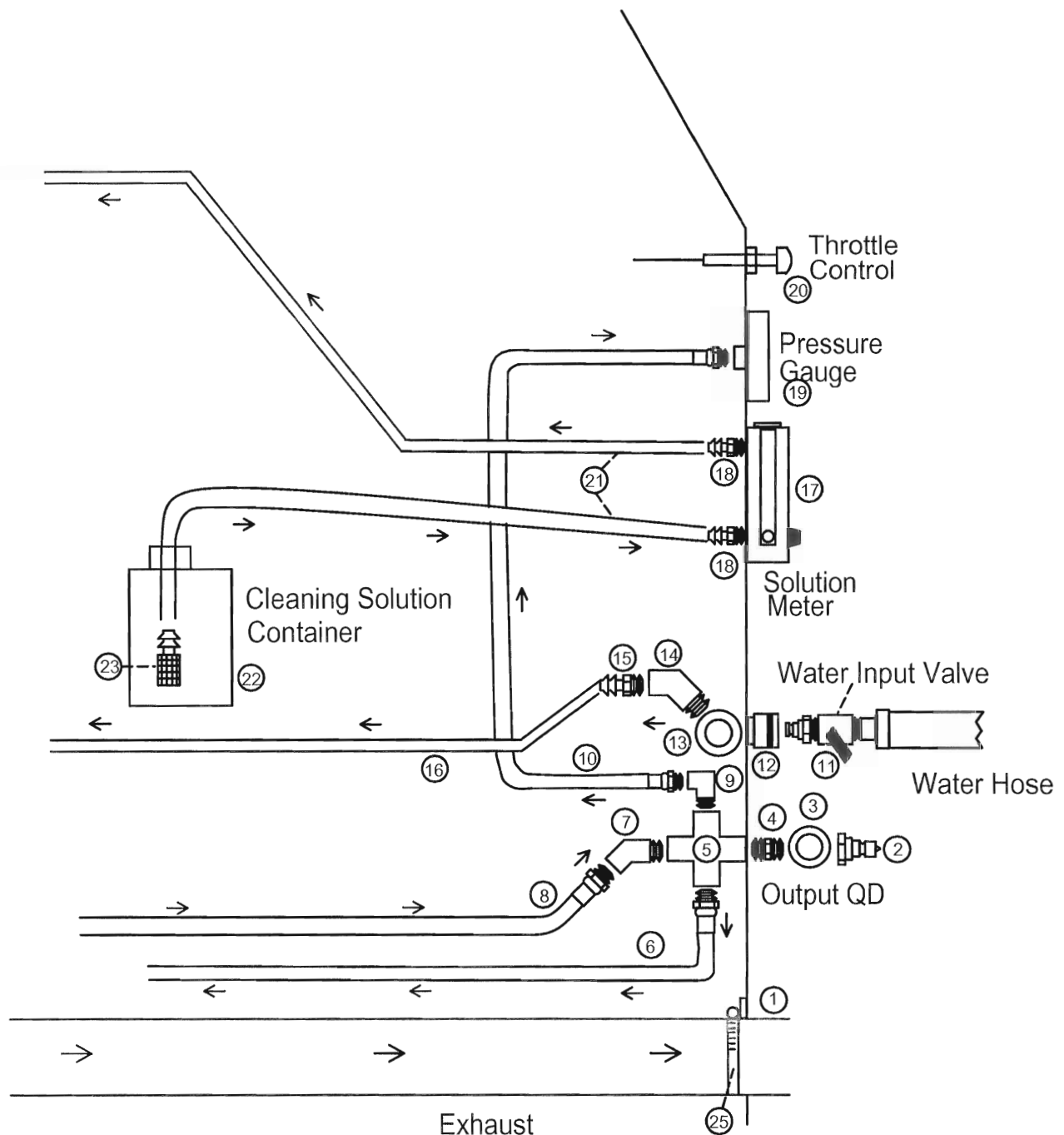

1	2909788	EXHAUST BRACKET	14	41-1C33-1	45 ∞ STREET ELBOW, 3/8
2	4131420	MALE QD	15	41-1M32	3/8 BARB
3	27-1122	SPACER, 1/4"	16	3941006	3/8 PUSH LOCK HOSE*
4	41-1H22	1/4 HEX NIPPLE	17	4146110	SOLUTION METER
5	41-1E02	1/4 CROSS	18	41-1M20	1/4hose X 1/8mpt BARB
6	3952031	CROSS TO ORIFICE SCREEN	19	44-C010	PRESSURE GAUGE
7	41-1C32-1	45 ∞ 1/4 STREET ELBOW	20	43-9A20	THROTTLE CONTROL
8	3937115	HOSE, ACCUM. TO PRESS. OUT	21	3950408	1/4 CLEAR BRAIDED HOSE*
9	41-1C12	1/4 STREET ELBOW	22	9980010	SOLUTION CONTAINER
10	3934418	GAUGE PULSE HOSE	23	41-5C17	BARBED STRAINER
11	15-1149	WATER INPUT VALVE ASSY.	24	3942036-2	HOSE-2.25x17"
12	4132665	QD, WATER INPUT	25	45-K013	HOSE CLAMP
13	27-1365	SPACER, 3/8			

*This hose is sold by the foot - indicate desired length.

Figure 8-2 Front Panel Side View

**FIGURE 8-2.1
FRONT PANEL PART NUMBERS**

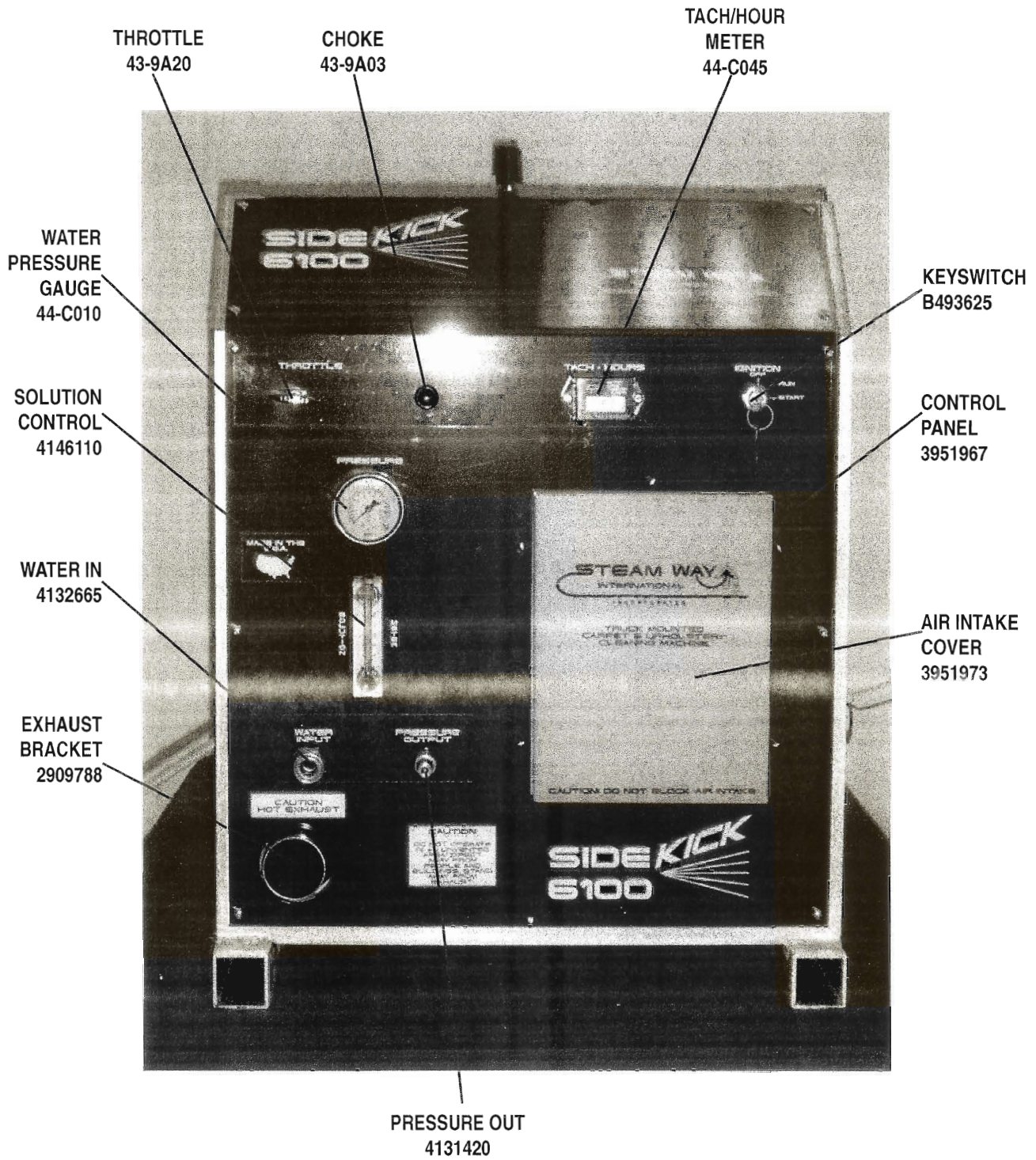

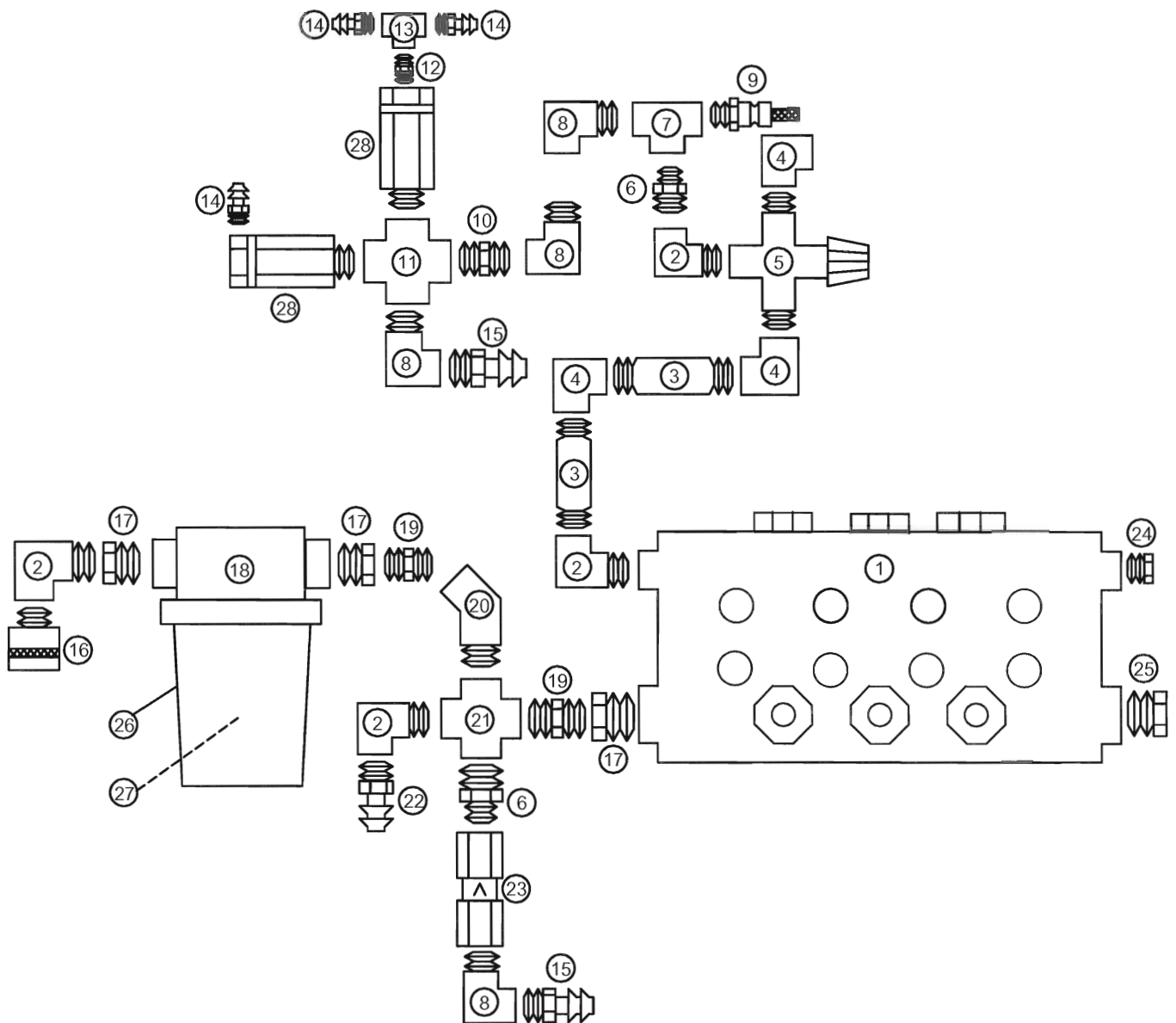

1	4100153	CAT PUMP	15	41-1M31	3/8hose x 1/4mpt BARB
2	41-1C13	3/8 STREET ELBOW	16	4131665	QD, 3/8, FEMALE
3	41-1G32	3/8 x 2 1/2 LONG NIPPLE	17	41-1A32	1/2 x 3/8 BUSHING
4	41-1C03	3/8 ELBOW	18	41-5C01	FILTER, IN-LINE
5	H3390-0079	UNLOADER	19	41-1H33	3/8 HEX NIPPLE
6	41-1H32	3/8 x 1/4 REDUCING NIPPLE	20	41-1C33-1	45° 3/8 STREET ELBOW
7	41-1B02	1/4 TEE	21	41-1E03	3/8 CROSS
8	41-1C12	1/4 STREET ELBOW	22	41-1M32	3/8hose x 3/8mpt BARB
9	1909879	ORIFICE BYPASS ASSEMBLY	23	4146505	1/4 CHECK VALVE
10	41-1H22	1/4 HEX NIPPLE	24	41-1N03	3/8 PIPE PLUG
11	41-1E02	1/4 CROSS	25	41-1N05	1/2 PIPE PLUG
12	41-1F01	1/8 HEX NIPPLE	26	41-5C01-4	BOWL FOR IN-LINE FILTER
13	41-1B01	1/8 TEE	27	41-5C01-1	SCREEN FOR IN-LINE FILTER
14	41-1M20	1/4hose x 1/8mpt BARB	28	C7140	THERMO VALVE

Figure 8-3 Water Pump & Regulator

**FIGURE 8-4
BELT AND DRIVE SYSTEM**

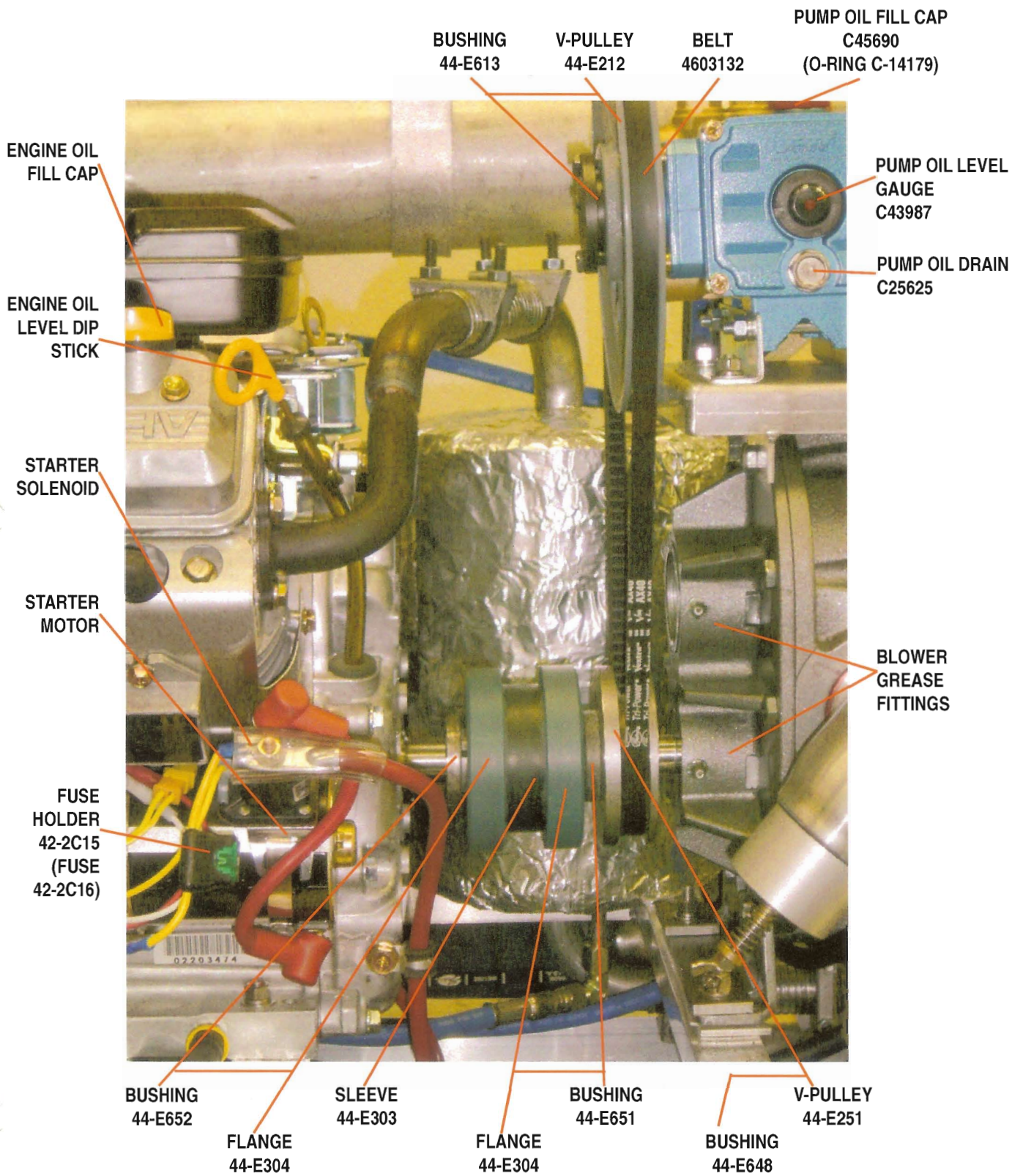

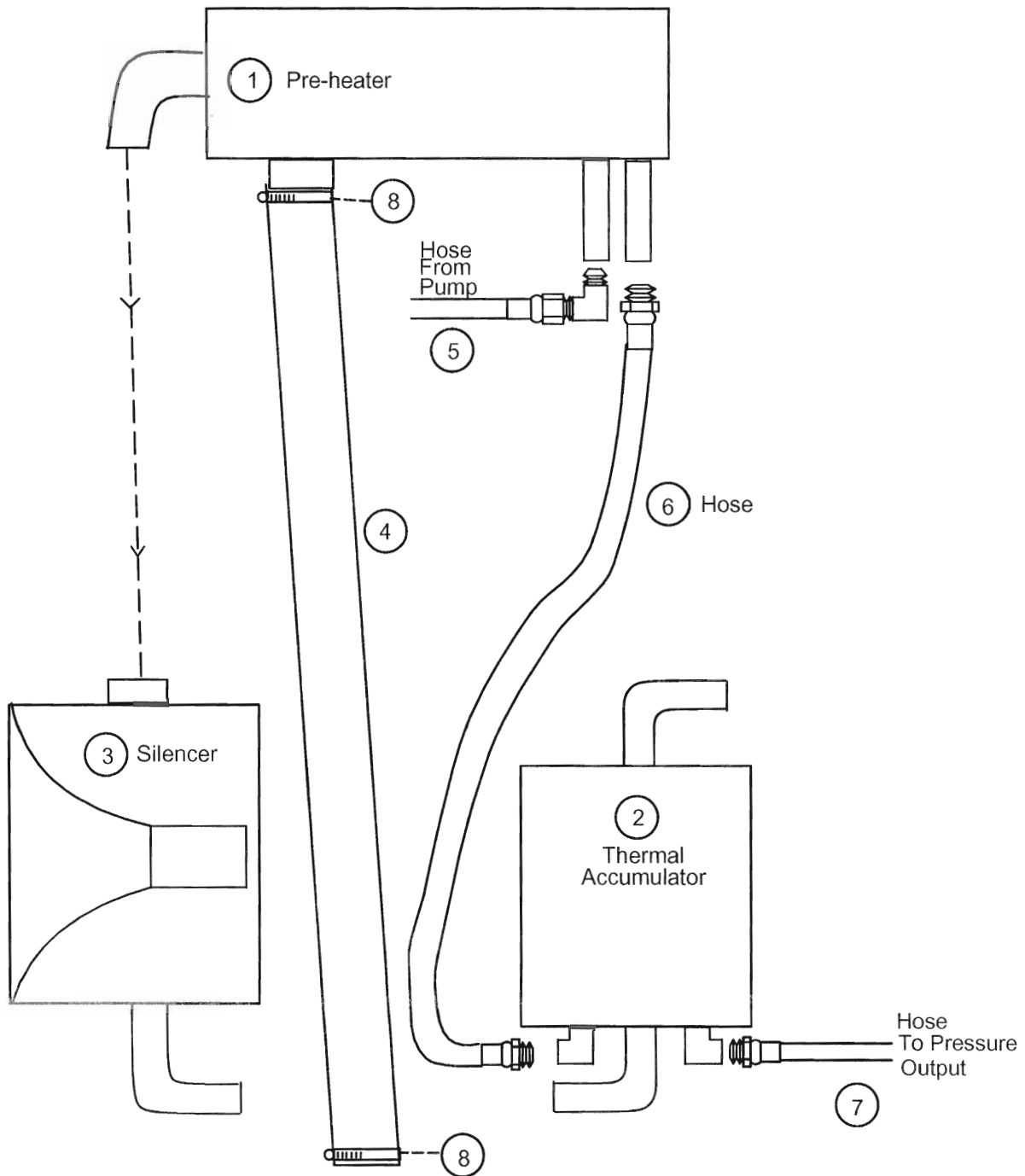

1	1909745	Pre-Heater	5	3937100	Hose, Pump to Pre-Heater
2	1909744	Thermal Accumulator	6	3937110	Hose, Pre-Heater to Accumulator
3	1909749	Silencer	7	3937115	Hose, Accumulator to Pressure Out
4	3942036-2	Hose, 2.25" x 17"	8	45-K013	Hose Clamp

Figure 8-5 Water Heating Components

STEAM WAY® SIDEKICK 6100 OWNERS MANUAL

STEAM WAY®



4550 Jackson Street, Denver, CO 80216
(800)447-8326 • (303) 355-3566 • Fax (303) 355-3516

STEAM WAY 
INTERNATIONAL
INCORPORATED

STEAM WAY SIDEKICK 6100



SIDE KICK 6100

THE PERFECT UPGRADE

Steam Way® quality and support are available in the perfect economical choice. Whether you are buying your first truck mount or you are adding to a fleet, the SideKick 6100 may well be the perfect upgrade and the perfect choice. The SideKick 6100 is simple to operate and maintain, making it ideal for standardizing a large operation. Compared to portable extractors, it makes carpet cleaning significantly faster and easier, and reduces drying time, making the SideKick 6100 the perfect upgrade for portable extractor operators. The SideKick 6100 will fit easily into most mini-vans, vans, and pick-up trucks, and many sports utility vehicles.

MATCHED FOR YOUR GROWING BUSINESS

Powered by the energy efficient, fuel-miser 16 HP Briggs & Stratton Air Cooled Engine, the SideKick 6100 meets or exceeds CARB and other government mandated emissions standards. The Roots 33 Vacuum recovery system produces up to 175 cfm of air movement, with an average of 145 cfm at 8" Hg. This provides you with plenty of vacuum recovery power for carpet cleaning and deflooding up to 150 to 200 feet away from the machine. The multisource heat exchange system will attain and maintain cleaning solution temperatures up to 180° F. A special water by-pass system prevents overheating the solution during deflooding, water removal, and upholstery cleaning. The industrial rated superior lasting CAT Solution Pump produces up to 800 psi in solution pressure.

PACKED WITH FEATURES

The SideKick 6100 may be an economical choice, but it is packed with operation, maintenance, and cleaning enhancement features. A solution pressure monitoring gauge, auto-inject solution flow meter, tachometer, hour meter, electric start ignition, and panel mounted throttle and choke control provide you with complete control. Its solution temperature attainment and cleaning performance rivals truck mounts costing thousands of dollars more. A pressure relief and heat control system provides safety against extreme pressure build-up when the machine operates without water flow.

PERFORMANCE ENHANCING OPTIONS AVAILABLE

Appearance and safety can be enhanced with the addition of a panel kit, a series of 4 marine aluminum panels that cover the top, sides, and back of the machine. The panel kit prevents objects from coming in direct contact with machine components and adds to your machine's professional appearance. If you choose the panel kit option, you may also want to consider adding the sound proofing kit that reduces the noise level of the machine up to 15%. This kit also includes an exhaust fan to keep the interior of the machine cooler. With specifically designed installations, the decibel level can be reduced to 65 decibels. Together, the Panel Kit and the Sound Proofing Kit have the additional benefit of adding 20 - 30° F (11 - 12° C) to the cleaning solution temperature. If space is at an absolute premium, you can eliminate space requirements for a large waste recovery tank by using an optional Automatic Waste Water Pumping System in a 30 gallon waste tank to pump the recovered waste water back into the home or business for disposal into the sewage treatment system.



Quick Reference Guide

Solution Heating	Multi-Source Heat Exchange System attains up to 180°F at 1.5 gpm waterflow
Solution Pressure	CAT Industrial produces up to 800 PSI
Vacuum	Roots 33 Vacuum Blower produces up to 175 cfm (with 145 cfm at 8" hg)
Engine	Briggs & Stratton 16HP air cooled engine

SideKick 6100

For More Details, See Machine Specification Sheet



4550 Jackson Street • Denver, CO USA 80216
(800) 447-8326 • (303) 355-3566 • Fax (303) 355-3516

www.steamway.com

STEAM WAY SIDEKICK 6100 STANDARD FEATURES



Machine Specifications

- **ENGINE:** Briggs & Stratton Vanguard 16 H.P. Air Cooled Engine with a twin cylinder, overhead valve engine that is low emissions.
- **VACUUM:** Roots 33 Vacuum Blower System creates up to 175 cfm airflow, with 145 cfm at 8" Hg.
- **HEATER:** Multi-Source Heat Exchange/Accumulator Solution Heating System - All stainless steel tubing for longer life. Attains and maintains solution temperatures up to 180°F. (82°C)
- **PUMP:** CAT 3CP High Performance Solution Pressure Pump with adjustable pressure up to 800 PSI. (55 Bar)
- Standard Performance Enhancement Features
 - Solution Pressure Monitoring Gauge
 - Auto-Inject Solution Flow Meter
 - Tachometer/Hour Meter
 - Electric Start Ignition
 - Panel Mounted Throttle & Choke Control
 - Pressure Relief And Heat System Provides Safety Against Extreme Pressure Build-Up When Machine Is Operating Without Water Flow
- Dimensions: 23"W x 29"H x 32 1/2"L
(58.4cm W x 73.60cm H x 82.5cm L).
- Weight: 350 lbs. (159kg).



Standard Starter Kit

- SideKick™ Module
- 50 Gallon (190 liters) Waste Recovery Tank With Filter System
- 12" (30 cm) High Pressure Economy Scrub Wand
- 100' (30.5 meters), 1/4" High-Temp Solution Pressure Hose
- 100' (30.5 meters), 2" High Performance Vacuum Hose
- 50' (15.2 meters) Water Hose w/ Intake Valve Assembly
- Installation Kit
- Six Gallon (22.7 liters) Fuel Tank or In-Line Fuel Hook-Up Kit
- 12V Battery
- One Solution Bottle (5 Gallon/19Liters)
- Operations And Maintenance Training
- Steam Way® Platinum Plus™ Protection Plan Warranty

Optional Enhancement Features

- Truck Pan
- 70 (265 liters) or 100 (379 liters) Gallon Usable Marine Aluminum Waste Recovery Tank
- Additional Pressure And Vacuum Hose
- Waste Water Filtration & Pumping System
- Panel Kit
 - Sound Proofing Kit
- Automatic Waste Water Pumping System
- Hose Reels
 - Auxiliary Water Tanks

Optional Performance Enhancing Features

✓ Panel Kit

A series of 4 marine aluminum panels cover the top, sides, and back of the machine. This panel kit enhances safety and operations by preventing objects from coming in direct contact with machine components. It also adds to your machine's professional appearance.

✓ Sound Proofing Kit

If you choose the Panel Kit option, you may also want to consider adding the Sound Proofing Kit that reduces the noise level of the machine up to 15%. This kit also includes an exhaust fan to keep the interior of the machine cooler. With specially designed installa-

tions, the decibel levels can be reduced to 65. The Panel Kit and Sound Proofing Kit add 20 - 30°F (11° - 12°C) to the cleaning solution temperature as an added benefit.

✓ Automatic Waste Water Pumping System

Eliminate the space requirements for a large waste tank with this 30 gallon (114 liters) waste water pumping station to pump water back into sewage treatment system.

Distributed By: